

Zeneer Series

Zeneer RO System

Pure System

"The best of best" which comes into the world by the ceaseless enthusiasm to be a top of the world!

■ Human Corporation was founded in June of 1993 and formulated from a single concept that we are going to produce the most advanced and effective "Water Purification System" available. Since the beginning HUMAN has acquired many patents and awards for its unique treatment system, sophisticated design and technique for the highest efficiency. Thanks to the customer's satisfaction, we can grow steadily in terms of corporate image and worldwide global brand reputation. We promise to you that we will put into all our efforts until we become an ever-growing global leader for Water Purification System.

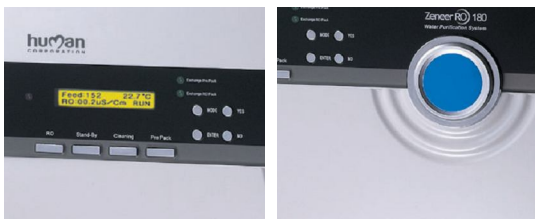

Flow Schematic

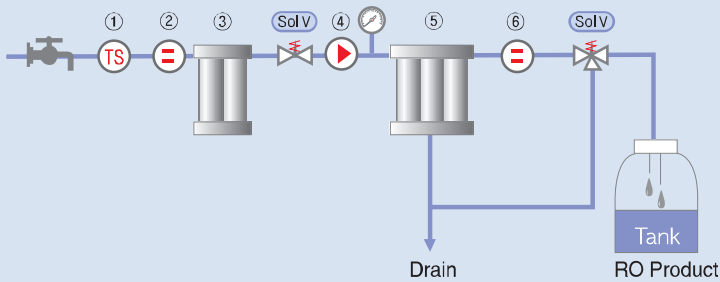

RO System	① Temp Sensor	② Feed Water Sensor	③ Pre Pack	④ Pump	⑤ RO Pack	⑥ Conductivity Sensor
-----------	---------------	---------------------	------------	--------	-----------	-----------------------

Brand Concept: "Zeneer" is a compound word of "Zero" and "Pioneer".
 "Zero" symbolizes perfectly no contaminant element in the Ultra Pure water from the Human Corp.'s UP system and "Pioneer" does a Human Corp. as a leading manufacturer of Water Purification System.

Rejection Rate

- Monovalent ions : 95 ~ 99%
- Polyvalent ions : 98 ~ 99%
- Microorganism : 99%
- Particles : 99%
- Organics : 99%
- Pyrogen : 99%

Features

- Certified CE
- Certified ISO 9001 (No : K-920)
- Obtained GD, QD Mark (Good Design, Qualified Design)
- Awarded the Korean Excellent Products
- Built-in RS 232C Port
- Built-in volumetric dispensing function by timer
- Auto regular flushing to maintain the optimum water quality level
- Programming by 2 steps of water quality for the filter exchange

Specifications

	Zeneer RO 180	Zeneer RO 280	Zeneer RO 380
Product flow rate (RO)	Max. 15L/Hr	Max. 25L/Hr	Max. 35L/Hr
Water quality display	<ul style="list-style-type: none"> • Feed water : 10 to 1000 $\mu\text{S}/\text{cm}$ • Temperature : 0 to 99.9$^{\circ}\text{C}$ • RO product : 0.2 to 250.0 $\mu\text{S}/\text{cm}$ 		
Controller	Microprocess one touch technology		
Display	16 x 2 characters backlight LCD digital display		
Controller functions	<ol style="list-style-type: none"> 1. Self test : Self-diagnosis for external & internal system operating conditions. 2. Auto cleaning : At the first switched-on, the system functions "auto-drain" to drain out all of the contaminated inside remaining waters. 3. Auto cleaning : <ol style="list-style-type: none"> ① Auto-drain time setting in proportion to inside contamination level ② Auto-cleaning when the system produces higher than setting value ③ Auto-cleaning for maintenance of optimum water purity even during switched-off ④ When the accumulated usage time is over ⑤ Manual cleaning function ⑥ Flushing time setting : 1 to 99 min. 4. Auto monitoring for RO value : After sensing RO value, auto-cleaning RO membrane 5. Volumetric dispensing : After setting of timer, the quantitative water production is available. 6. Filter exchange indicator : Programmable by 2 steps (Pre Pack, RO Pack) <ol style="list-style-type: none"> ① 1st alert message : Reminder for filter pack exchange ② 2nd alert message : Filter pack must be exchanged 7. Auto monitoring for feed water : When the purity and temperature of feed water are exceeding the setting value, the system will be stopped automatically. 8. Built-in RS 232C Port : Various applications, maintenance and print are available by interfacing with PC 		
Safety functions	<ol style="list-style-type: none"> 1. Low pressure of tap water : Auto/manual operating modes 2. Automatic pump stop functions : <ol style="list-style-type: none"> ① Low pressure ② Tank full ③ Suspension of tap water supply ④ Over conductivity & temp of feed water 3. Automatic adjustable function for products drain volume 4. Automatic system off : <ol style="list-style-type: none"> ① When the conductivity of feed water is getting worse ② When the temperature of feed water is increasing 		
Standard accessories	.Pre Pack .RO Pack .Level sensor .Manual .Power cord		
Optional accessories	Pretreatment system, Software, Post treatment system (Ion Pack)		
Dimensions (W x D x H)	300 x 460 x 460mm		
Power	230V, 50/60Hz, 60W		
Ion Pack	2 Hole / 3 Hole Pack		